

1 SITE LOCATION PLAN
1 : 2500

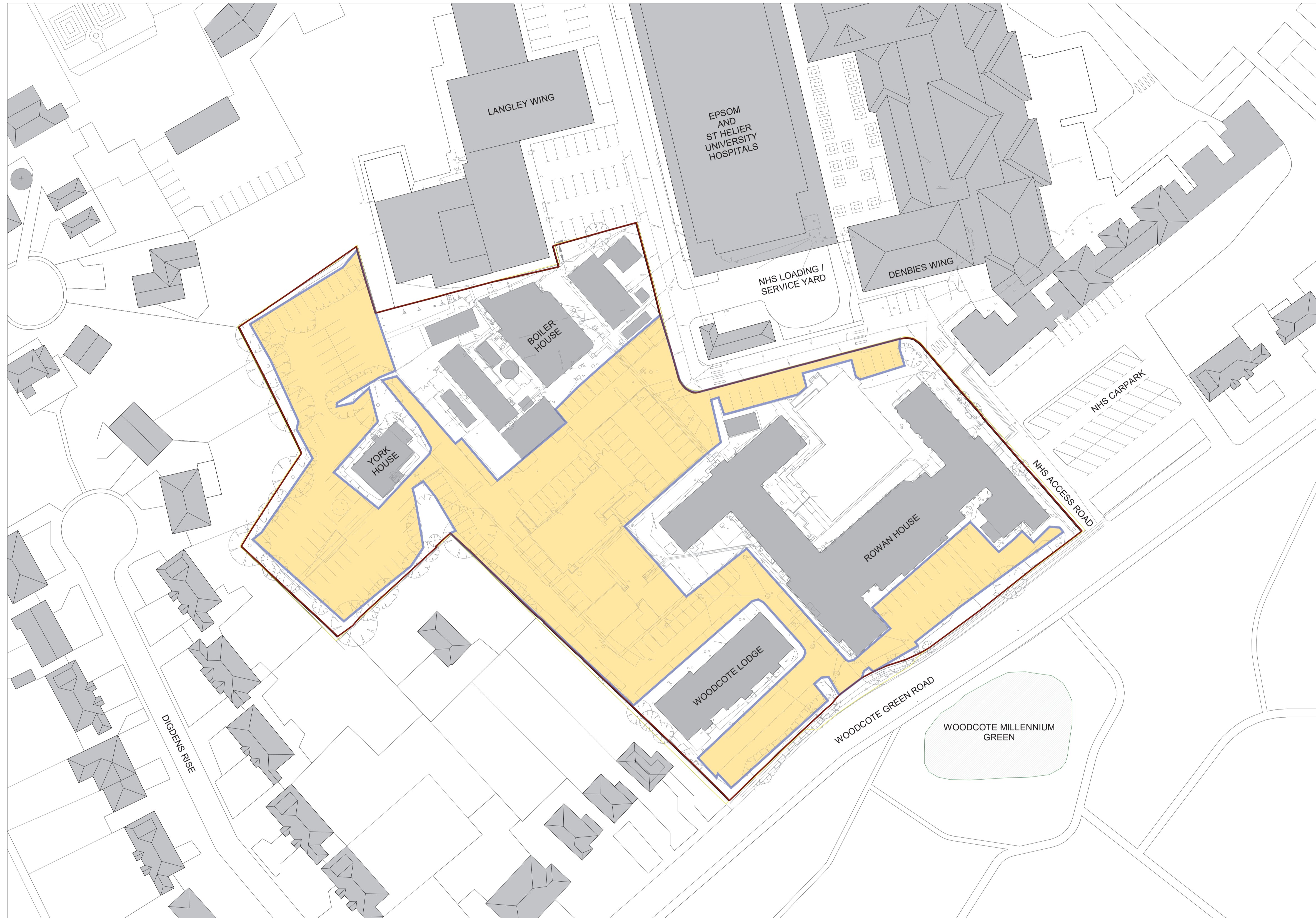

Existing & Access Areas (6583 sqm)

2 EXISTING PLAN
1 : 500

REV.	DATE	FOR PLANNING	DR
DESCRIPTION	BY		
PURPOSE OF ISSUE		STATUS	
PLANNING			

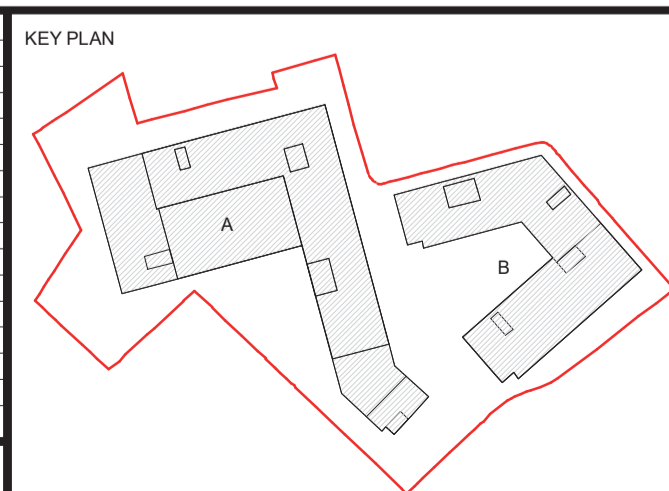

- NOTES
1. ALL DIMENSIONS IN MILLIMETERS (mm) AND LEVELS IN METERS (m) ABOVE NATIONAL DATUM.
 2. DO NOT SCALE FROM THIS DRAWING. ONLY WRITTEN DIMENSIONS SHALL BE USED.
 3. THIS DRAWING IS TO BE READ IN CONJUNCTION WITH ALL RELEVANT ARCHITECTURAL DRAWINGS AND SPECIFICATIONS AS WELL AS ALL RELEVANT INFORMATION FROM THE STRUCTURAL, MEP AND CIVIL ENGINEERS.
 4. THIS DRAWING HAS BEEN PREPARED IN ACCORDANCE WITH THE SCOPE OF APPOINTMENT WITH THE CLIENT AND IS SUBJECT TO THE TERMS OF THAT APPOINTMENT AND SHOULD ONLY BE USED FOR THE PURPOSE FOR WHICH IT IS INTENDED.

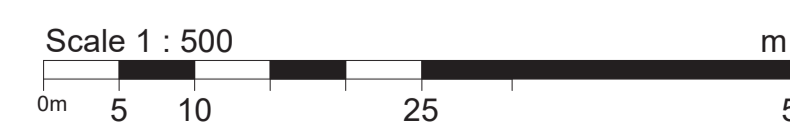

marchese partners
Sydney · Brisbane · Canberra · Melbourne · Adelaide
Kuala Lumpur · Auckland · Christchurch · London
Madrid
Marchese Partners International Pty Ltd | Metal Box Factory | Unit
GG.212.30 | Great Guildford St | London SE1 0LS | United Kingdom
P +44 020 3735 9755 | W www.marchesepartners.com

CLIENT	GUILD LIVING
PROJECT	GUILD LIVING @ EPSOM

DRAWING TITLE		SCALE @ A1	
SITE LOCATION AND EXISTING PLAN		As indicated	
DISCIPLINE	ARCHITECTURE	SCALE @ A1	As indicated
DRAWN	DESIGNED	CHECKED	APPROVED
SN	DR	DR	RK
DRAWING No	EPS001-MPI-XX-ZZ-DR-A-00-001	REV	-