

KEY

1 BED (S)

1 BED (M)

1 BED (L)

2 BED (C)

2 BED (S)

2 BED (M)

2 BED (L)

2 BED (XL)

3 BED (M)

GCS-A

GCS-B

KW (1B)

KW (2B)

GCR-A

GCR-B

GCR-C

CHILDassist

RETAIL

CARE AMENITY LFoH

CARE AMENITY BoH

WELLNESS LFoH

WELLNESS BoH

F&B LFoH

F&B BoH

AMENITY LFoH

AMENITY BoH

AMENITY SUPPORT LFoH

AMENITY SUPPORT BoH

PLANT

PARKING

CIRCULATION BoH

CIRCULATION LFoH

NOTE:

Drawing to be read in conjunction with schedule of accommodation.

Refer to: EPS001-MPI-XX-ZZ-SH-A-800001

1 LEVEL 04 MASTERPLAN
1 : 500

| REV | DATE | FOR PLANNING | DR |
|------------------|----------|--------------|--------|
| | 05-02-21 | FOR PLANNING | DR |
| PURPOSE OF ISSUE | | | STATUS |
| PLANNING | | | |

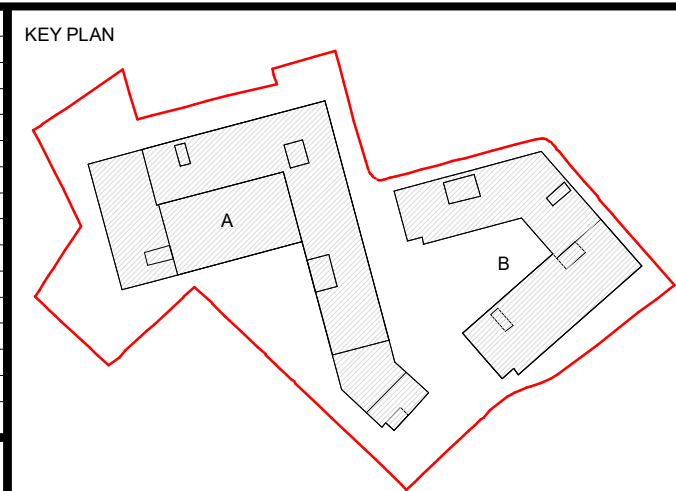

- NOTES
1. ALL DIMENSIONS IN MILLIMETERS (mm) AND LEVELS IN METERS (m) ABOVE NATIONAL DATUM.

2. DO NOT SCALE FROM THIS DRAWING. ONLY WRITTEN DIMENSIONS SHALL BE USED.

3. THIS DRAWING IS TO BE READ IN CONJUNCTION WITH ALL RELEVANT ARCHITECTURAL DRAWINGS AND SPECIFICATIONS AS WELL AS ALL RELEVANT INFORMATION FROM THE STRUCTURAL, MEP AND CIVIL ENGINEERS.

4. THIS DRAWING HAS BEEN PREPARED IN ACCORDANCE WITH THE SCOPE OF APPOINTMENT WITH THE CLIENT AND IS SUBJECT TO THE TERMS OF THAT APPOINTMENT AND SHOULD ONLY BE USED FOR THE PURPOSE FOR WHICH IT IS INTENDED.

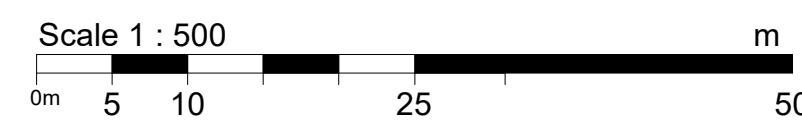

marchese
partners

Sydney · Brisbane · Canberra · Melbourne · Adelaide
Kuala Lumpur · Auckland · Christchurch · London
Madrid
Marchese Partners International Pty Ltd | Metal Box Factory | Unit
GG 212 30 | Great Guildford St | London SE1 0LS | United Kingdom
P +44 020 3735 9755 | W www.marchesepartners.com

| | |
|---------|----------------------|
| CLIENT | GUILD LIVING |
| PROJECT | GUILD LIVING @ EPSOM |

| | | | |
|------------------------------|----------|---------|------------|
| DRAWING TITLE | | | |
| LEVEL 04 MASTERPLAN | | | |
| DISCIPLINE | | | SCALE @ A1 |
| ARCHITECTURE | | | 1 : 500 |
| DRAWN | DESIGNED | CHECKED | APPROVED |
| SN | DR | DR | RK |
| DRAWING No | | | REV |
| EPS001-MPI-ZZ-04-DR-A-01-104 | | | — |